

CONFIDENTIAL INFORMATION: THIS DOCUMENT AND CONTAINED INFORMATION ARE THE PROPERTY OF RUSSTECH ENGINEERING COMPANY, INC. THE RECIPIENT, BY RECEIPT AND RETENTION HEREOF, ACKNOWLEDGES THAT THE INFORMATION RECEIVED IS CONFIDENTIAL, DEVELOPED OVER TIME AT SIGNIFICANT EXPENSE, AND THAT DISCLOSURE THEREOF TO THIRD PARTIES WILL CAUSE IRREPARABLE HARM TO RUSSTECH. THE RECIPIENT, BY THE RECEIPT AND RETENTION OF SUCH INFORMATION, AGREES TO MAINTAIN SUCH INFORMATION IN CONFIDENCE, TO NOT DISCLOSE IT TO THIRD PARTIES, AND TO RETURN IT, AND ALL COPIES OR DERIVATIVES THEREOF, IN ANY FORM, TO RUSSTECH, UPON REQUEST.

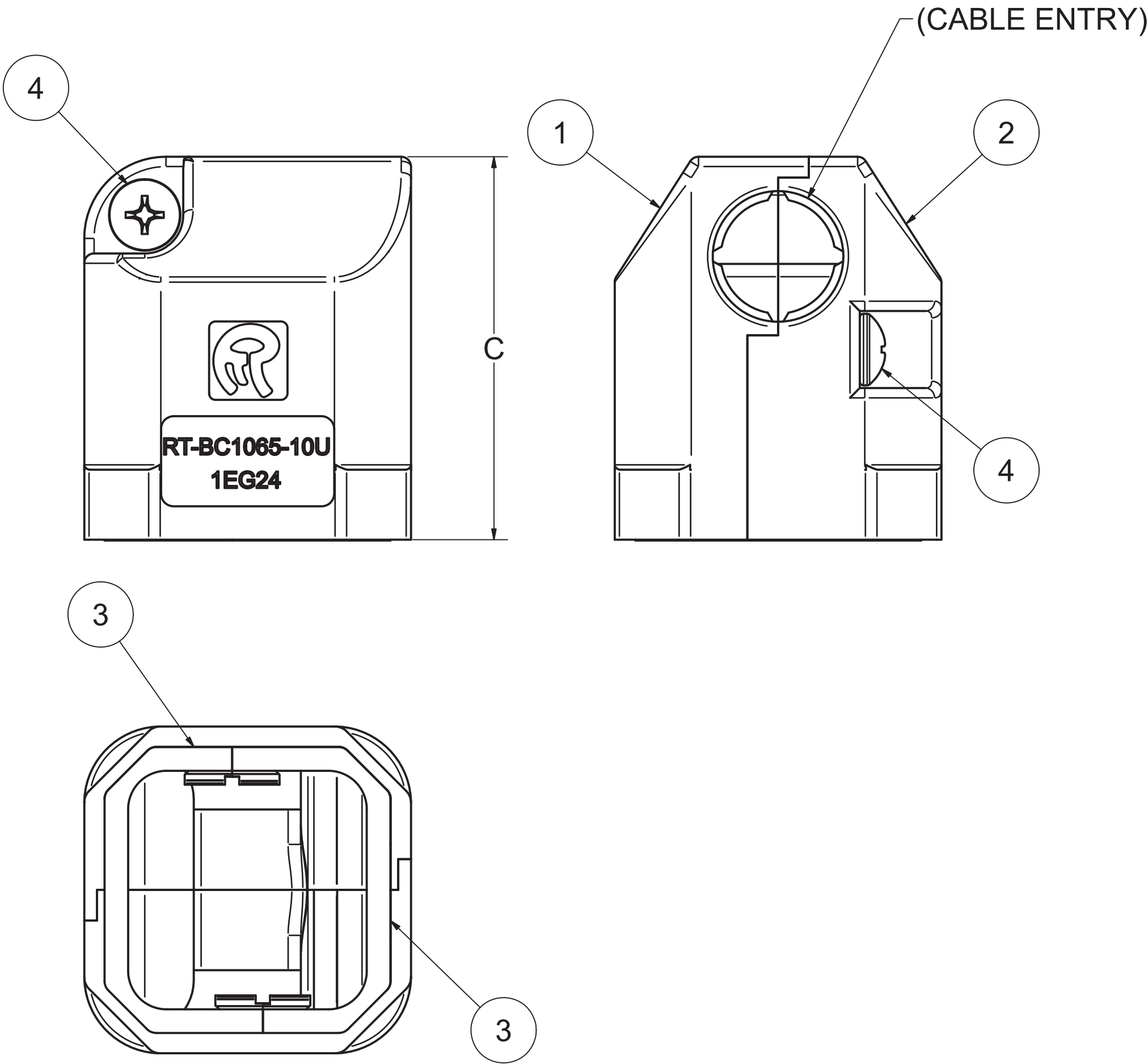
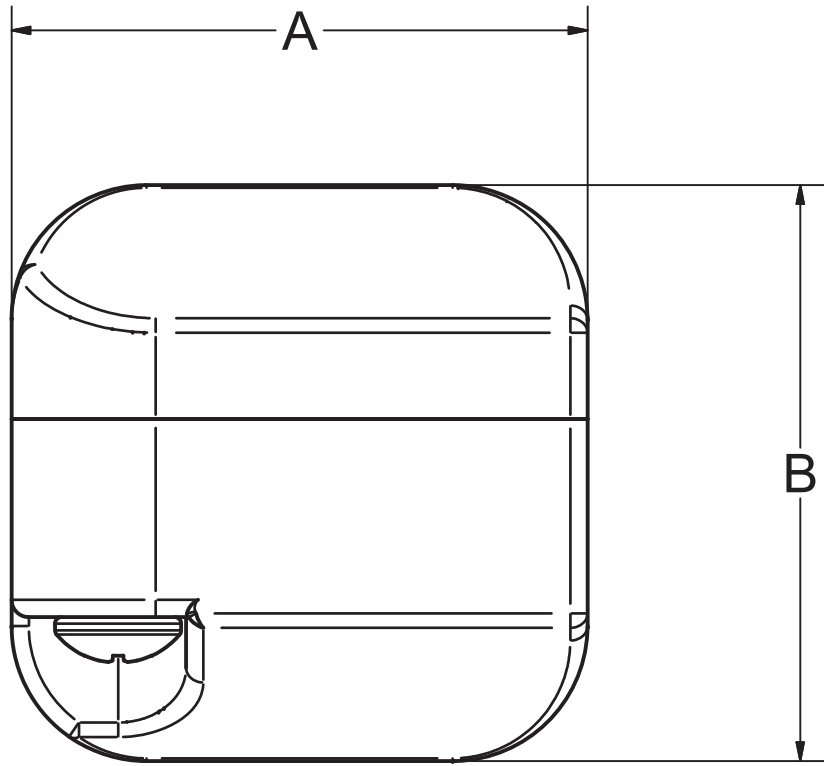

NOTES:

- DIMENSIONS APPLY AFTER FINISH
- MATERIAL:
  - BACKSHELL: ULTEM-2310
  - ADAPTOR CLIP: ULTEM-2310
  - HARDWARE: STAINLESS STEEL
- FINISH:
  - BACKSHELL: ELECTROLESS NICKEL PLATE
  - ADAPTOR CLIP: ELECTROLESS NICKEL PLATE
- PACKAGE TO PREVENT DAMAGE
- IDENTIFY AS SHOWN

5.1 PART NUMBER TO READ:

RT-BC1065-10U

- DENOTES COMPOSITE CONSTRUCTION
- CABLE ENTRY SIZE (MM)
- PRODUCT FAMILY BASE NUMBER
- BASE PREFIX

- ASSEMBLY HARDWARE INCLUDED
- SIZE #1 PHILLIPS DRIVER BIT RECOMMENDED

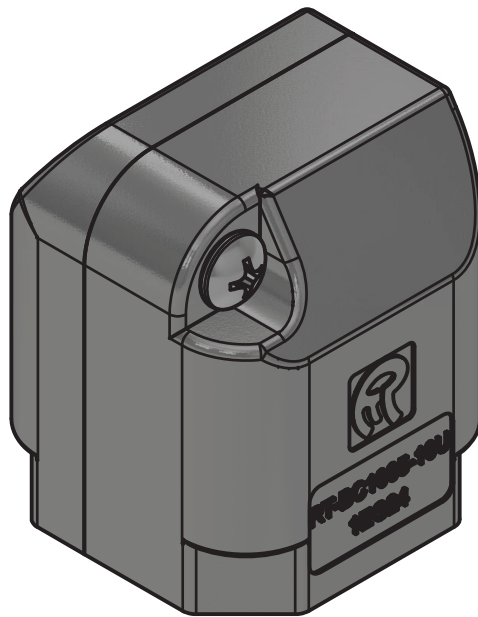

REVISION HISTORY						
ZONE	REV	DESCRIPTION	CHECKED BY	DATE	APPROVED BY	DATE
--	NEW	INITIAL RELEASE.	--	--	--	--
B7	A	ADJUSTED WEIGHT BASED ON PRODUCTION PART	B. DUNCAN	01/14/22	J. GILMAN	01/14/22
D6		UPDATED ITEM 4 PART NUMBER				
F5		ADDED SALES MODEL REFERENCE				
--	B	REVISED PER ECO00111.	Wm Bryon Duncan	Digitally signed by Wm Bryon Duncan Date: 2024.10.22 16:39:56 -0700	Jason Gilman	Digitally signed by Jason Gilman Date: 2024.10.23 11:56:42 -0700

TABLE 1						
DASH NO. 5.1	CABLE ENTRY REF. ONLY	CABLE O.D. REF. ONLY	WEIGHT (LBS) REF. ONLY	A	B	C
-10U	[10]	0.15-0.40	0.026	1.00	1.00	1.17

4	2	4X1/2-PNPH-TRSS	SCREW, TRILOBULAR, THREAD CUTTING, 1/2" LENGTH	RUSSTECH
3	2	RTBS0001-02	EN4165 COMPOSITE ADAPTOR CLIP	RUSSTECH
2	1	RT-BC1065-10U-R	EN4165 COMPOSITE EMI BACKSHELL, 90 DEGREE EXIT, RIGHT HALF	RUSSTECH
1	1	RT-BC1065-10U-L	EN4165 COMPOSITE EMI BACKSHELL, 90 DEGREE EXIT, LEFT HALF	RUSSTECH
ITEM	QTY	PART NUMBER	DESCRIPTION	MFGR

PARTS LIST				
TECHNICAL REFERENCE RT-BC1065-10U_Sales_1.stp		RUSSTECH ENGINEERING COMPANY, INCORPORATED 4416 RUSSELL ROAD, SUITE A MUKILTEO, WA 98275, USA		
UNLESS OTHERWISE SPECIFIED DIMENSIONS ARE IN DECIMAL INCHES WITH METRIC IN BRACKETS  TOLERANCES ARE:  .X ± 0.1 .XX ± 0.03 .XXX ± 0.010 ANGLES ± 0.5°  REMOVE ALL BURRS & SHARP EDGES	APPROVALS		MONO MODULAR EN4165 / BACC65 / ARINC 809 BACKSHELL  EMI, COMPOSITE, 90 DEGREE EXIT	
	DRAWN BY	B. LEBSON 10/17/2024		
	CHECKED BY	J. GILMAN 10/20/2021		
	ENGINEER	B. LEBSON 10/20/2021		
APPROVED BY	H. GILMAN 10/20/2021		B	
	SCALE 3 : 1		AUTODESK-INVENTOR DEPARTMENT ENGINEERING SHEET 1/1	
SIZE D		CAGE CODE 1EG24	DRAWING NUMBER RT-BC1065-S	