

CONFIDENTIAL INFORMATION: THIS DOCUMENT AND CONTAINED INFORMATION ARE THE PROPERTY OF RUSSTECH ENGINEERING COMPANY, INC. THE RECIPIENT, BY RECEIPT AND RETENTION HEREOF, ACKNOWLEDGES THAT THE INFORMATION RECEIVED IS CONFIDENTIAL, DEVELOPED OVER TIME AT SIGNIFICANT EXPENSE, AND THAT DISCLOSURE THEREOF TO THIRD PARTIES WILL CAUSE IRREPARABLE HARM TO RUSSTECH. THE RECIPIENT BY THE RECEIPT AND RETENTION OF SUCH INFORMATION, AGREES TO MAINTAIN SUCH INFORMATION IN CONFIDENCE, TO NOT DISCLOSE IT TO THIRD PARTIES, AND TO RETURN IT, AND ALL COPIES OR DERIVATIVES THEREOF, IN ANY FORM, TO RUSSTECH, UPON REQUEST.

REVISION HISTORY						
ZONE	REV	DESCRIPTION	CHECKED BY	DATE	APPROVED BY	DATE
--	A	INITIAL RELEASE, SUPERSEDES RC11063-S.	--	--	--	--

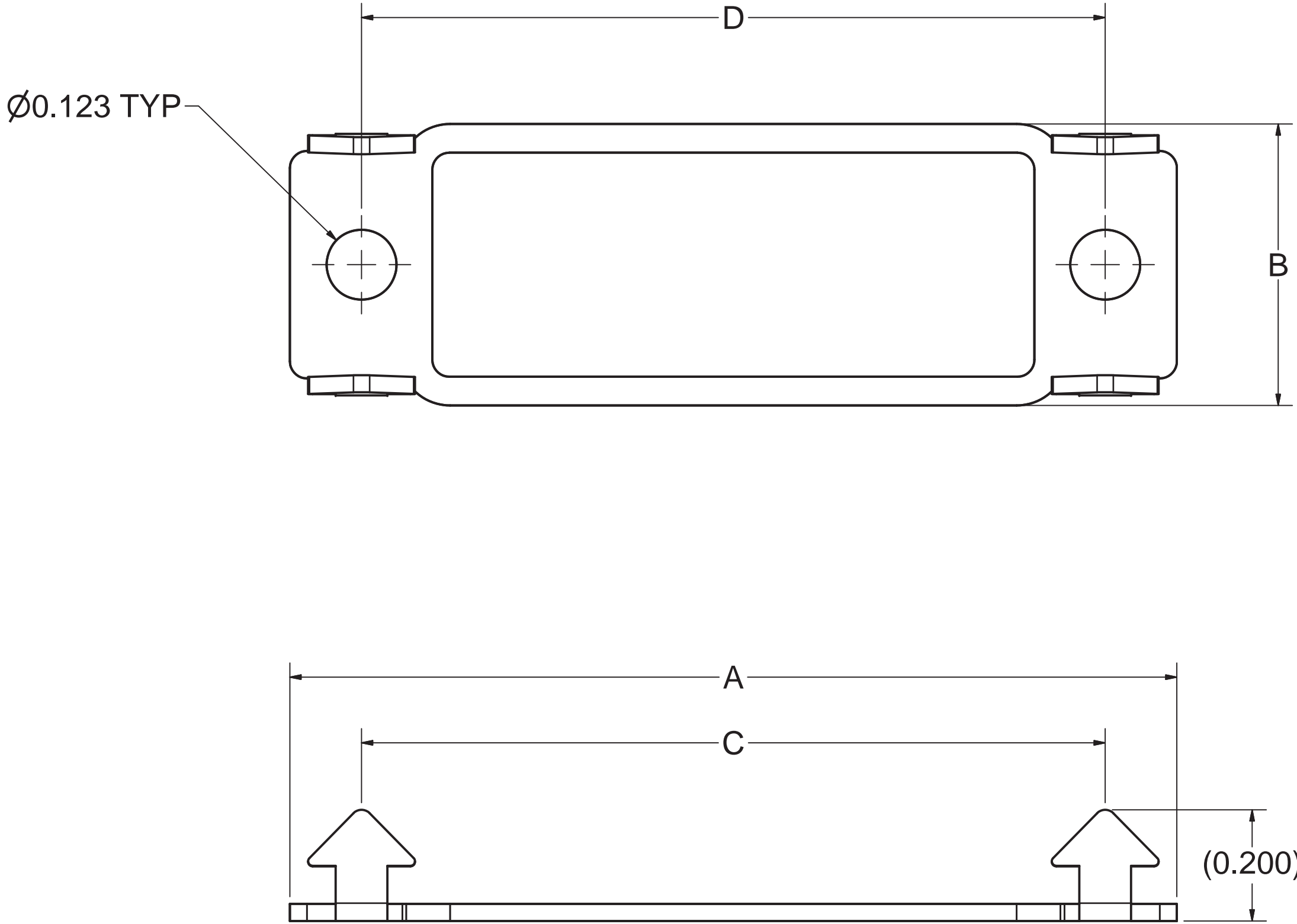

DIMENSIONS (INCHES)					
PART NUMBER	CONNECTOR BACKSHELL SIZE	A INCHES	B INCHES	C INCHES	D INCHES
RA-LT0024-201	1	1.23	0.50	0.98	0.98
RA-LT0024-202	2	1.56	0.50	1.30	1.30
RA-LT0024-203	3	2.10	0.50	1.85	1.85
RA-LT0024-204	4	2.75	0.50	2.50	2.50
RA-LT0024-205	5	2.65	0.61	2.40	2.40
RA-LT0024-206	6	2.75	0.67	2.50	2.50

NOTES:

- DIMENSIONS APPLY AFTER FINISH
- MATERIAL: 304 ANNEALED STAINLESS STEEL, 0.030 THICK
- FINISH: N/A
- PACKAGE TO PREVENT DAMAGE
- IDENTIFY AS SHOWN
- RECOMMEND USE OF 4-40 PHILIPS PAN HEAD SCREW (EXAMPLE: MS51957-14)
6.1 RA-LT0024-20X PART NUMBER DOES NOT INCLUDE HARDWARE
6.2 RA-LT0024-20XH PART NUMBER DOES INCLUDE HARDWARE (QTY 2, MS51957-14 SCREWS)
- IT IS THE USERS RESPONSIBILITY TO ENSURE PROPER CONTACT ENGAGEMENT
- INSTALL MOUNTING SCREWS USING 5-7 IN-LBF OF TORQUE MAX
- INSTALL BOTH SCREWS LOOSELY BEFORE FULLY TIGHTENING THEM TO THE RECOMMENDED TORQUE IN NOTE 8. FOLLOWING THIS REQUIREMENT ENSURES THE RECEIVER IS PROPERLY ALIGNED AND WON'T SPIN/BEND WHEN THE FIRST SCREW IS FULLY TIGHTENED

TECHNICAL REFERENCE

UNLESS OTHERWISE SPECIFIED DIMENSIONS ARE IN DECIMAL INCHES WITH METRIC IN BRACKETS

TOLERANCES ARE:

.X ± 0.1
.XX ± 0.03
.XXX ± 0.010
ANGLES ± 0.5°

REMOVE ALL BURRS & SHARP EDGES

APPROVALS

DRAWN BY
J. WON
11/7/2023

CHECKED BY
Wm Bryon Duncan
2025.06.30 09:52:56 -07'00'

ENGINEER
Edward Chung
2025.06.30 08:58:28 -07'00'

APPROVED BY
Ben Lebson
2025.06.30 10:56:44 -07'00'

RUSSTECH ENGINEERING

RUSSTECH ENGINEERING COMPANY, INCORPORATED
4416 RUSSELL ROAD, SUITE A
MUKILTEO, WA 98275, USA

TITLE

SLIDE LATCH RECEIVER

STANDARD PROFILE

APPROX. MAX PANEL THICKNESS: 0.03125"

SIZE
D

CAGE CODE
1EG24

DRAWING NUMBER
RA-LT0024-20X-S

REV.
A

SCALE
5 : 1

AUTODESK-INVENTOR

DEPARTMENT
ENGINEERING

SHEET
1/1