

CONFIDENTIAL INFORMATION: THIS DOCUMENT AND CONTAINED INFORMATION ARE THE PROPERTY OF RUSSTECH ENGINEERING COMPANY, INC. THE RECIPIENT, BY RECEIPT AND RETENTION HEREOF, ACKNOWLEDGES THAT THE INFORMATION RECEIVED IS CONFIDENTIAL, DEVELOPED OVER TIME AT SIGNIFICANT EXPENSE, AND THAT DISCLOSURE THEREOF TO THIRD PARTIES WILL CAUSE IRREPARABLE HARM TO RUSSTECH. THE RECIPIENT, BY THE RECEIPT AND RETENTION OF SUCH INFORMATION, AGREES TO MAINTAIN SUCH INFORMATION IN CONFIDENCE, TO NOT DISCLOSE IT TO THIRD PARTIES, AND TO RETURN IT, AND ALL COPIES OR DERIVATIVES THEREOF, IN ANY FORM, TO RUSSTECH, UPON REQUEST.

REVISION HISTORY					
ZONE	REV	DESCRIPTION	CHECKED BY	DATE	APPROVED BY
--	A	INITIAL RELEASE.	--	--	--
--	B	REVISED PER ECO00239	Wm Bryon Duncan	2025.10.31 16:30:13 -07'00	Ben Lebson

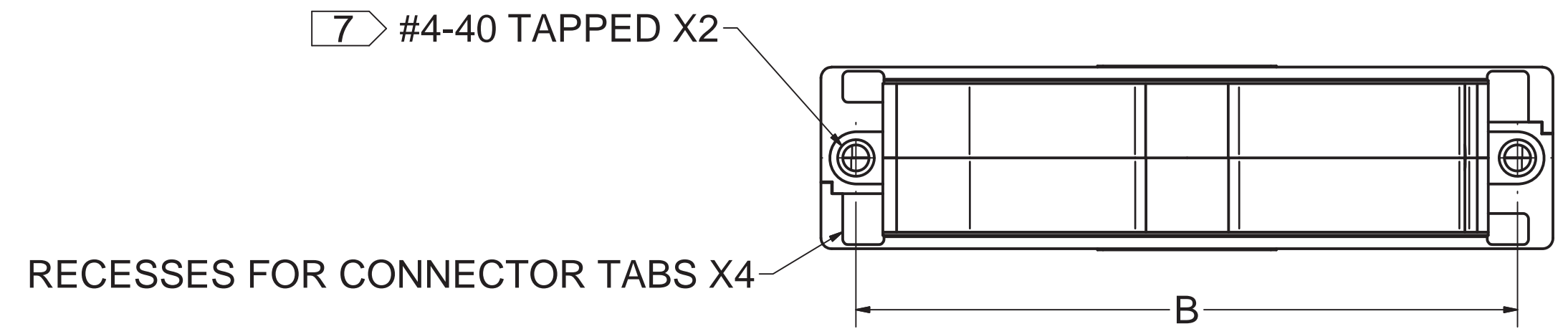
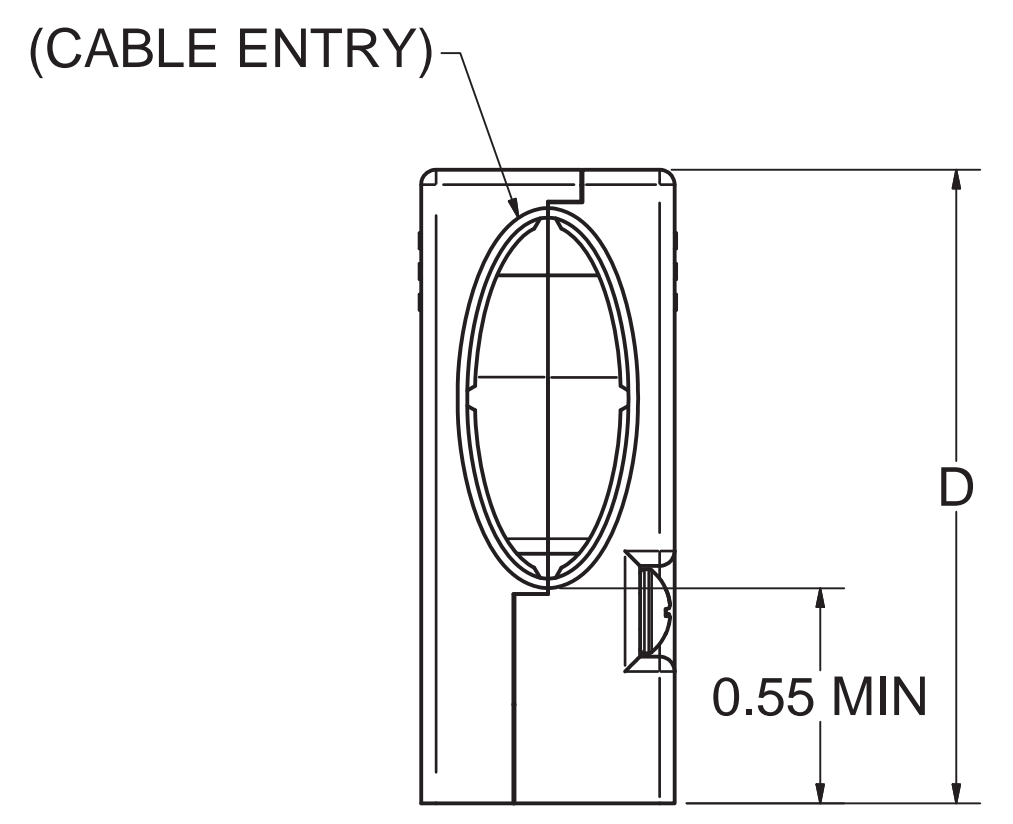
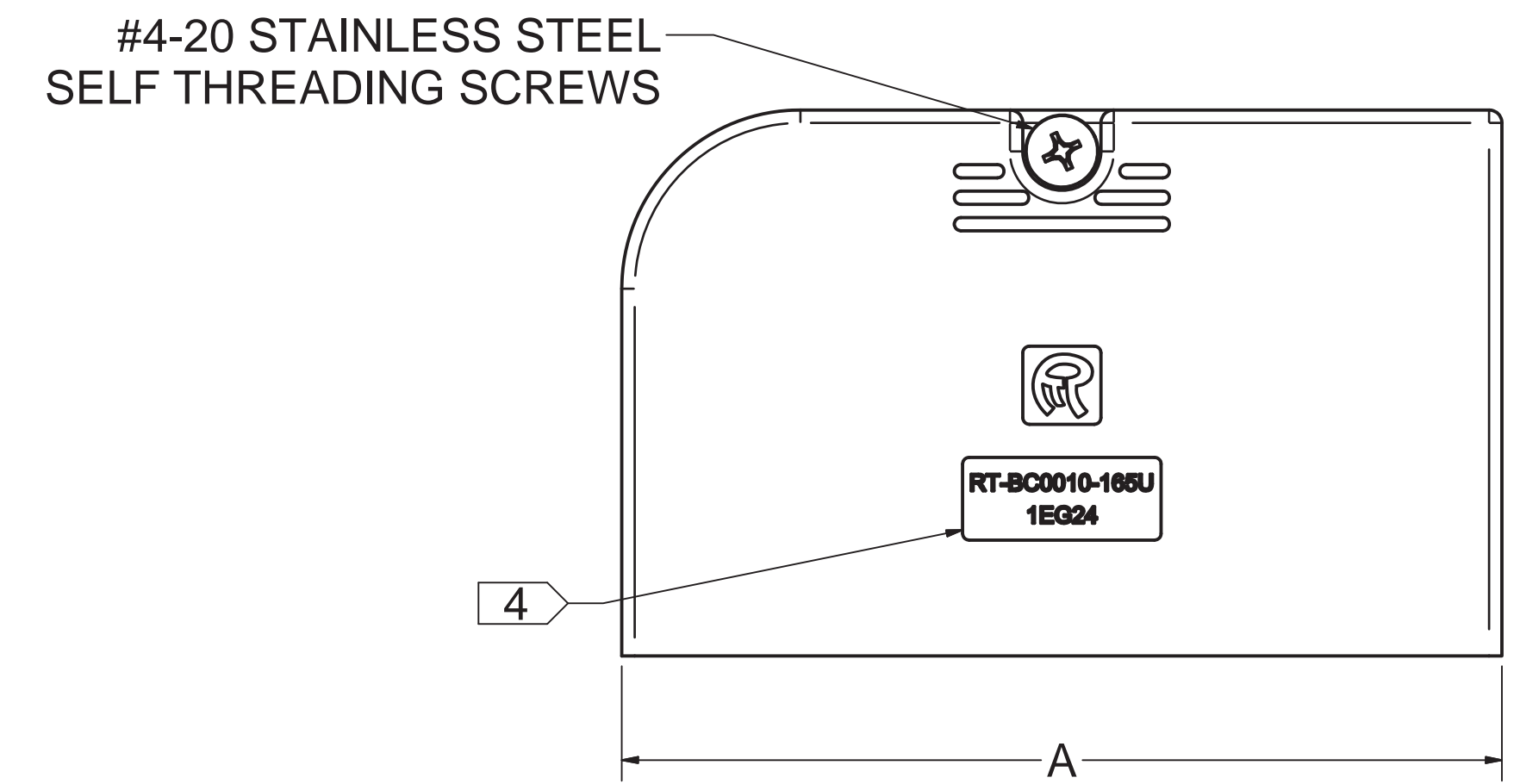
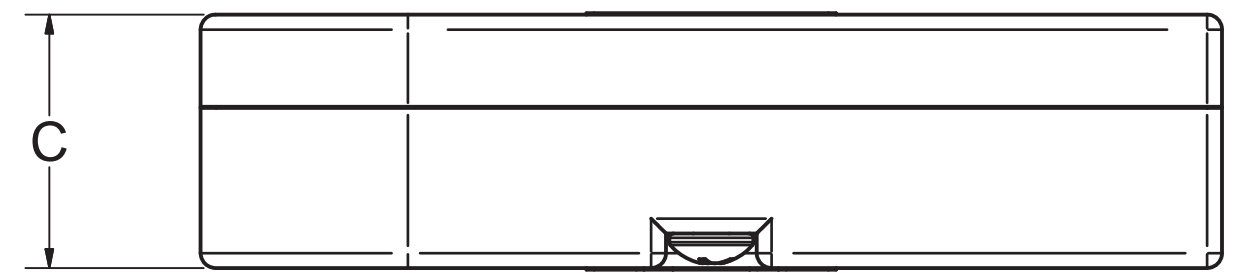
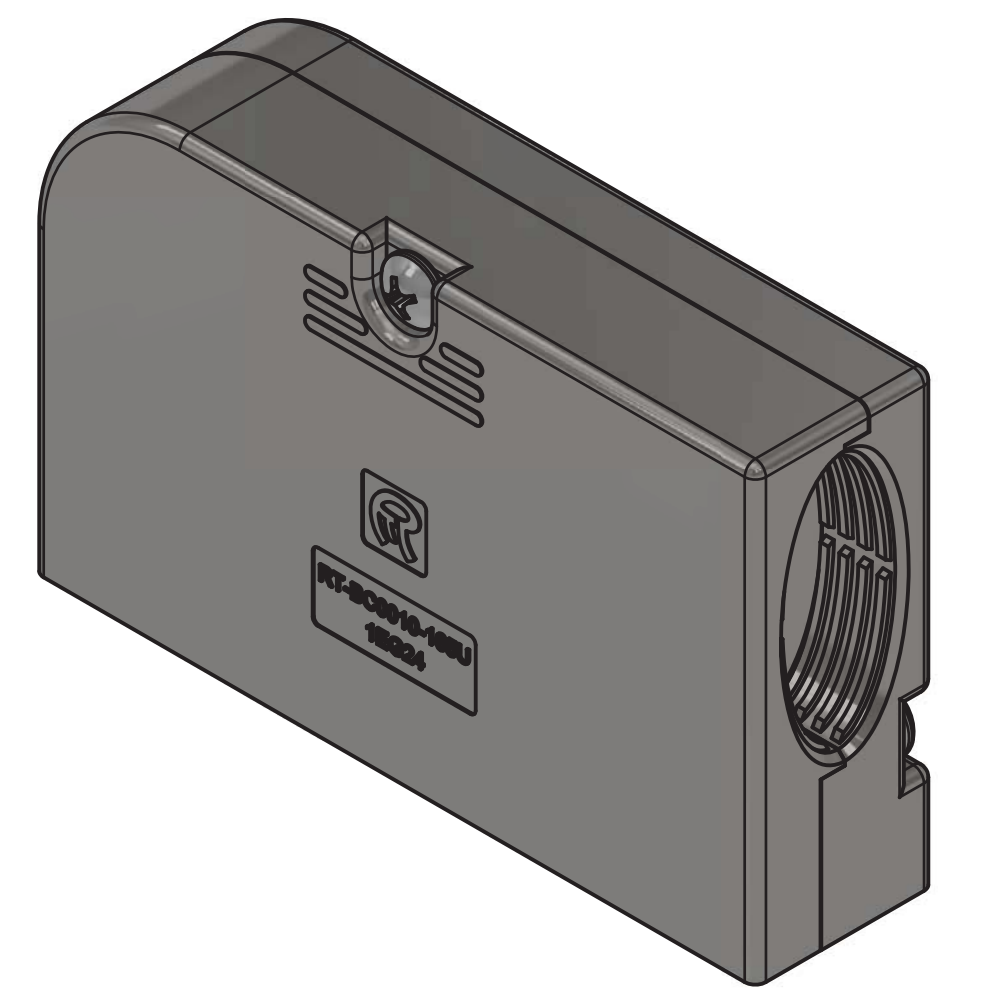

TABLE 1 [4]

GENERAL DIMENSIONS

DASH NO.	APPROX EQUIVALENT CABLE EXIT DIAMETER REF. ONLY	CABLE O.D. SIZE REF. ONLY	SHELL SIZE	WEIGHT (LBS) REF. ONLY	A MAX	B ±0.005	C ±0.010	D ±0.020
-091U	[9]	0.15 - 0.35	1	0.024	1.240	0.984	0.540	1.080
-092U	[9]	0.15 - 0.35	2	0.028	1.560	1.312	0.540	1.100
-152U	[15]	0.30 - 0.58	2	0.032	1.575	1.312	0.540	1.450
-123U	[12]	0.20 - 0.49	3	0.038	2.110	1.852	0.540	1.200
-163U	[16]	0.40 - 0.65	3	--	2.110	1.852	0.540	1.600
-164U	[16]	0.40 - 0.65	4	--	2.760	2.505	0.540	1.650
-165U	[16]	0.40 - 0.65	5	--	2.660	2.404	0.660	1.650
-236U	[23]	0.50 - 0.90	6	--	2.760	2.500	0.750	1.620



NOTES:

- DIMENSIONS APPLY AFTER FINISH**
- MATERIAL:**
 - BACKSHELL:** ULTEM 2310
 - HARDWARE:** STAINLESS STEEL
- FINISH:** ELECTROLESS NICKEL PLATING PER AMS2404
- PART NUMBER TO READ:**
RT-BC0010-XXYU

COMPOSITE CONSTRUCTED PART
 BACKSHELL SHELL SIZE
 APPROXIMATE EQUIVALENT CABLE ENTRY DIAMETER IN MM

- PACKAGE TO PREVENT DAMAGE, ASSEMBLY HARDWARE INCLUDED**
- ALL BACKSHELL KITS TO COME WITH 2 SHELL HALVES, 2 THREAD CUTTING SCREWS FOR SHELL SIZES 1 & 2, AND 3 THREAD CUTTING SCREWS FOR SHELL SIZES 3-6. INCLUDED SCREWS TO BE USED FOR ASSEMBLING THE TWO HALVES TOGETHER.**
- BACKSHELL KITS DO NOT INCLUDE #4-40 SCREWS**
- ALL DASH NO. ARE ROHS COMPLIANT**



TECHNICAL REFERENCE	RUSSTECH ENGINEERING COMPANY, INCORPORATED 4416 RUSSELL ROAD, SUITE A MUKILTEO, WA 98275, USA	
UNLESS OTHERWISE SPECIFIED DIMENSIONS ARE IN DECIMAL INCHES WITH METRIC IN BRACKETS	APPROVALS DRAWN BY: E. CHUNG 11/25/2024 CHECKED BY: B. DUNCAN 5/1/2025 ENGINEER: E. CHUNG 5/1/2025 APPROVED BY: B. LEBSON 5/1/2025	COMPOSITE 90° EMI BACKSHELL 90° EXIT, SPLIT SHELL STYLE FOR USE WITH M24308 COMPLIANT CONNECTORS
TOLERANCES ARE: .X ±0.1 .XX ±0.03 .XXX ±0.010 ANGLES ±0.5°	REMOVE ALL BURRS & SHARP EDGES	SIZE: D CAGE CODE: 1EG24 DRAWING NUMBER: RT-BC0010-S SCALE: 2 : 1 AUTODESK-INVENTOR DEPARTMENT: SALES SHEET: 1/1